

[Overview](#)[OS X](#)[iPad](#)[iPhone](#)[iPod + iTunes](#)[Resources](#)**iPad**[Vision](#)[Hearing](#)[Physical & Motor Skills](#)**Accessibility Solutions
for iPhone and iPad.**

You can find a variety of hardware and software products (sold separately) that adapt iPhone and iPad for specific needs. [Learn more](#)

Physical and Motor Skills

iPad includes a variety of innovative features that make it more accessible to users with impaired physical or motor skills.



Thin, Light Design

iPad is incredibly thin and light, making it easy to hold and convenient to carry. Users who require additional assistance holding their iPad can use the iPad Smart Cover. You can stand iPad up to view the screen or lay it down at an angle to type or interact.



Large Multi-Touch Display

iPad features a large, high-precision, touch-sensitive display that requires no physical force, just simple contact with its surface. You can also use the built-in Zoom function to magnify the entire screen, so it's easier to touch smaller items on the screen such as links, buttons and images.

AssistiveTouch

Built-in AssistiveTouch lets you enter Multi-Touch gestures using one finger or a stylus (sold separately). It also supports the use of adaptive input devices, like headsets and switches, so you can experience the full capability of iPad.

Tactile Buttons

iPad includes several easy-to-press physical buttons: the Sleep/Wake button, located on the top edge; the silent and volume control buttons, located on the upper-right edge; and the Home button, centred below the display.

Multiple Orientations

iPad works in multiple orientations, so you can use it in portrait or switch it to landscape to suit your needs. With its built-in accelerometer, it automatically senses when the orientation has changed and adjusts the screen so it's always right side up. You can also lock the screen orientation, so that it doesn't change when you don't expect it.

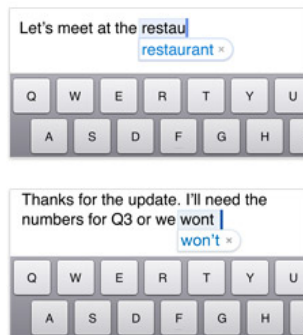

Intelligent Onscreen Keyboard with Predictive Text Entry

The onscreen keyboard appears when you need it, and smartly adapts by displaying convenient keys such as ".com" and "@," saving you keystrokes. The nearly full-size intelligent QWERTY keyboard includes advanced technologies such as autocapitalization and autocorrection that make it easier to type and avoid typos and misspellings. You can also have autocorrections and capitalizations spoken aloud to further assist you. iPad even learns as you type, so your speed increases almost immediately.

External Keyboards

For those who require them, physical keyboards are an option. iPad supports the Apple Wireless Keyboard and most other Bluetooth wireless keyboards that use the Apple keyboard layout. Other Bluetooth keyboards may work too, although some unique or specialized keys may not be supported or work as expected.



Apple Stereo Headset Compatibility

iPad works with a variety of headsets, including Apple earphones and in-ear headphones that have a high-performance microphone capsule built into the cord. Control music playback or record your voice in compatible applications when you click the microphone capsule on your headset.

Sync Automatically

iTunes can synchronize your latest music, movies, podcasts, contacts, calendar events, and photos via Wi-Fi or when you connect iPad to your Mac or PC. This feature makes it easy to manage your content with the minimum number of keystrokes or mouse clicks.

Hearing